

DURABELLA

DATA SHEET P.A.T.1

Durabella Ireland
 23 Maple Drive
 The Paddocks
 Termon Abbey
 Drogheda
 Co. Louth

OFFICE & RETAIL ENVIRONMENTS

The partial access floor has been developed for areas where cable management is necessary but where full computer room access flooring is unlikely to be required. Many office environments have determined layouts early in the structure of the building and do not change dramatically during the course of its life.

It is our experience as suppliers and installers of raised flooring that in as much as 80% of the installations completed using full access floors, less than 10% of the total floor area is likely to require access during its working life. It is commonly believed that providing a full access floor during the build will accommodate the use for any future business type. In reality the use of the working area is likely to be determined by exits, toilets, kitchens and walkways within the layout of the office, which are unlikely to change dramatically.

Accessibility in partial access floors can be adapted to accommodate all aspects of modern office, they are usually a more robust structure and can easily accommodate the use of the sub floor as a ventilation plenum and are easier to secure.

TIMBER SYSTEMS : PC22

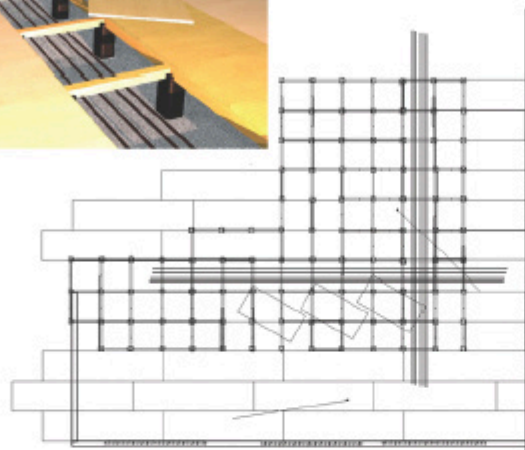
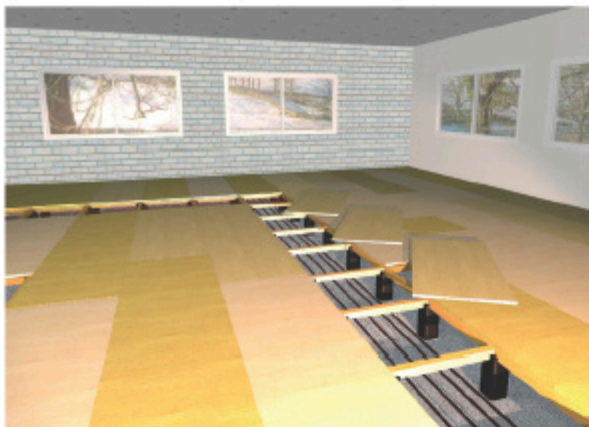
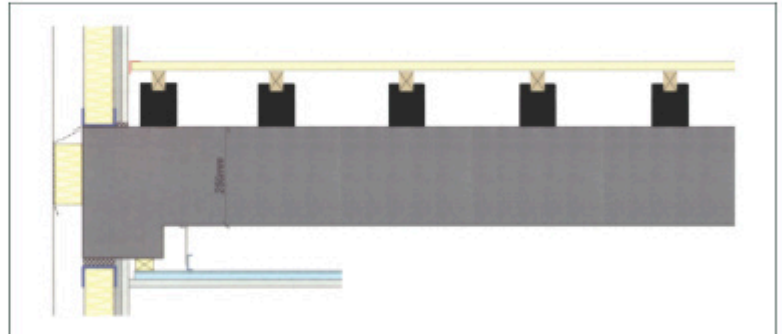

Partial access floors have been developed to cater for the office and retail requirements using access traps and cable management systems. The advantage of a partial access floor is a consistent homogenous floor surface capable of taking heavy traffic without distortion and they are also usually more cost effective.

Some Durabella partial access pedestals have been developed to accommodate isolation pads, protecting the floor from any surrounding vibration created within the main structure of the building, this can be particularly useful in factory, airport or high road traffic environments and will help protect any sensitive computer systems from potentially damaging vibration. Durabella partial access anti-vibration pads have the ability to resist vibration under load.

The Durabella partial access support systems are designed for applications where the sub floor is out of level, it is an extension of the principle applied to the full access flooring system. It is particularly effective in overcoming difficult site problems and can be laid with an overall depth between 55mm and 500mm.

The straight lay partial access batten system can be used in conjunction with screed finishes or where the sub-base has a reasonable level tolerance. In both cases cables run between the battens. The key to effective partial access flooring is to ensure an understanding of workstations, permanent walkways and partitioning requirements, prior to the installation of the floor.

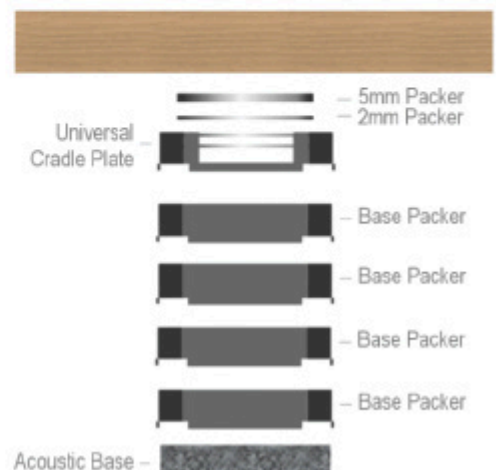

DURABELLA

DATA SHEET
 P.A.T.1.

Access Ducting

With the partial access systems parallel lines of access ducting will usually be positioned at right angle to the batten line. All access ducting will have an inverted 'T' section placed along under each edge and supporting the ends of each duct panel. Trunking and Services should be positioned to allow a central batten support down the length of the duct to support the 600mm removable panel. Alternatively battens may be placed at right angles butting up to the trunking thus giving appropriate support to the duct panel.

Access Duct Panels

Access duct panels for the partial access systems are 22mm thick in size and 1200mm x 600mm square edge profile. A lifting device is fitted in every fourth panel but these can be inserted in each panel with countersunk screws and cups so that they may be lifted to gain access to the subfloor cavity.

Service Installation

Service trunking which will contain electrical, telephone and other cables may be laid in the subfloor cavity. If it is installed before installation of the flooring system it must be set out at an appropriate grid for the spacing of the batten/cradles. Advice on positioning of the trunking together with the degree of flexibility provided by the different floor systems is freely available upon request from our Technical Department or from our Technical Sales Representative.

Cut-Outs For Outlet Boxes

Panels can be cut to accommodate outlet boxes with or without rebated edges. If these are cut in the factory they must be cut in a set position in the board, alternatively they may be made on site during the installation process, between lines of battens. Appropriate floor support must be placed in the cavity in the vicinity of the cut-out where required.

